

**SAURER.**



**Types, sizes, surfaces.**

Temco Separator Rollers VR

# Separator rollers VR

## Separator rollers figures

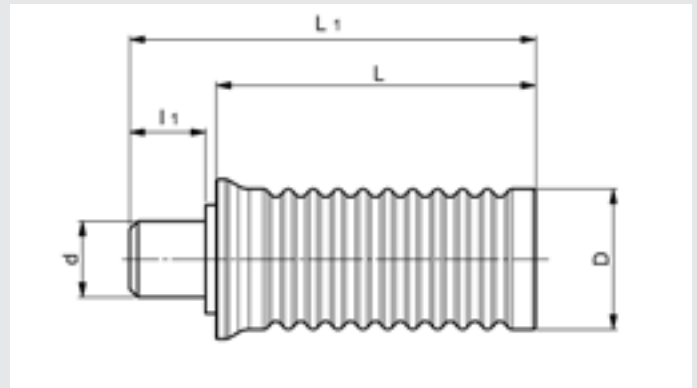
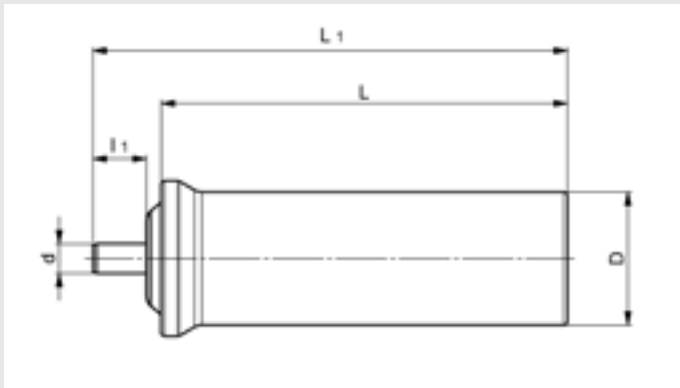

## Overview

Type	Color of Cap	*Max. yarn speed [m/min]	*Max. yarn temp. [°C]	*Max. radial load [N]	Dimensions D [mm]	L [mm]	L <sub>1</sub> [mm]	d [mm]	l <sub>1</sub> [mm]	Surface
VR2137-N**	●	1500	70	100	21.2	37	52.5	Ø8	15.5	HC
VR2143-N**	●	1500	70	100	21.2	43	58.5	Ø8	15.5	HC
VR2143-NT	●	1500	130	100	21.2	43	58.5	Ø8	15.5	HC
VR2147-3-N	●	1500	70	100	21.2	47	62.5	Ø8	11	HC
VR2147-3-NT	●	1500	130	100	21.2	47	62.5	Ø8	11	HC
VR2158-N**	●	1500	70	100	21.2	58	76.8	Ø8	18.8	HC
VR2158-NT	●	1500	130	100	21.2	58	76.8	Ø8	18.8	HC
VR2158-1-N**	●	1500	70	100	21.2	58	83	M8	13	HC
VR2158-1-NT	●	1500	130	100	21.2	58	83	M8	13	HC
VR2158-3-N**	●	1500	70	100	21.2	58	76.8	Ø8	14.5	HC
VR2158-3-NT	●	1500	130	100	21.2	58	76.8	Ø8	14.5	HC
VR2158-3-H	●	2000	70	100	21.2	58	76.8	Ø8	14.5	HC
VR2158-3-HT	●	2000	130	100	21.2	58	76.8	Ø8	14.5	HC
VR2177-N**	●	1500	70	100	21.2	77	95.8	Ø8	18.8	HC
VR2177-NT**	●	1500	130	100	21.2	77	95.8	Ø8	18.8	HC
VR2177-H	●	2000	70	100	21.2	77	95.8	Ø8	18.8	HC
VR2177-HT	●	2000	130	100	21.2	77	95.8	Ø8	18.8	HC
VR2177-1-N**	●	1500	70	100	21.2	77	102	M8	13	HC
VR2177-1-NT	●	1500	130	100	21.2	77	102	M8	13	HC

- = normal speed low temperature
- = normal speed high temperature
- = higher speed low temperature
- = higher speed high temperature

## Overview

Type	Color of Cap	* Max. yarn speed [m/min]	* Max. yarn temp. [°C]	* Max. radial load [N]	Dimensions D [mm]	L [mm]	L <sub>1</sub> [mm]	d [mm]	l <sub>1</sub> [mm]	Surface
VR2177-3-N**	●	1500	70	100	21.2	77	95.8	Ø8	14.5	HC
VR2177-3-NT**	●	1500	130	100	21.2	77	95.8	Ø8	14.5	HC
VR2177-3-H	●	2000	70	100	21.2	77	95.8	Ø8	14.5	HC
VR2177-3-HT	●	2000	130	100	21.2	77	95.8	Ø8	14.5	HC
VR2177-17-N	●	1500	70	100	21.2	77	95.8	Ø8	14.5	Ceramic
VR2177-17-NT	●	1500	130	100	21.2	77	95.8	Ø8	14.5	Ceramic
VR2258-00**		4500	70	50	22	58	75	Ø8	14.5	HC
VR2275-00**		5000	70	50	22	75	100	Ø8	25	HC
VR2298-00		5000	70	50	22	98	115	Ø8	14.5	HC
VR22120-00**		5000	70	50	22	120	137	Ø8	14.5	HC
VR2577-00		800	180	100	25/21.2	77	95.5	Ø8	18.5	HC
VR2655		1100	80	200	26/24	55	80.2	M6	18.2	Ceramic
VR2659-02		1400	80	130	26/23	59	75	Ø14	14	Ceramic
VR3077-00		1500	260	120	30	77	97	Ø16	19	HC
VR3098-04		1500	260	120	30	98	118	Ø16	17	HC
VR3098-05		1500	260	120	30	98	127	Ø8	15.5	HC
VR3581-00		4000	150	110	35	81.3	105.6	Ø12.6	22.3	Ceramic
VR3670-00		4000	70	110	36	70	94.2	Ø16	22.2	HC
VR3690-03		1900	260	120	36	90	119	Ø8	15.5	HC
VR3698-07**		2000	260	190	36	98	118	Ø16	18	HC
VR36110-09**		1900	260	120	36	110	128.5	Ø8	14.5	HC
VR36110-11		4000	90	110	36	110	130	Ø16	18	HC
VR40110-07**		2000	260	190	40	110	137	Ø12	24	HC
VR50150-06**		4500	160	250	50	150	215.7	Ø32	64.5	HC
VR50210-05**		4000	160	250	50	210	255	Ø32	45	HC
VR50210-06		4000	160	250	50	210	255	Ø32	45	Ceramic
VR50245-06		4000	160	250	50	245	285	Ø32	45	HC
VR50245-07		4000	160	250	50	245	285	Ø32	40	Ceramic
VR50300-00-HS		5500	190	250	50	300	372.5	Ø26	67.5	Ceramic
VR54228-00		4000	160	250	54	228	287.5	Ø25.4	54	Ceramic
VR60240-07**		4700	160	550	60	238	278	Ø46	39	HC
VR60240-08		4700	160	550	60	238	278	Ø46	39	Ceramic
VR60280-00		4700	160	550	60	280	320	Ø46	39	Ceramic
VR60320-12**		4700	160	700	60	320	360	Ø46	39	HC
VR60320-13		4700	160	700	60	320	360	Ø46	39	Ceramic

\* At coincidence of all three maximum values please contact us or fill in our checklist.

You will find the checklist under <http://temco.saurer.com/de/Products/Bearings/Separator-Rollers-VR/Downloads>

\*\* = Standard types

Saurer Technologies GmbH & Co. KG  
Engineered Bearing Solutions  
Fuldaer Str. 19  
97762 Hammelburg  
Germany  
T +49 9732 87 0  
F +49 9732 87 310  
sales.bearings@saurer.com

Saurer (JiangSu) Textile Machinery  
Company Limited  
Shanghai Branch Company  
36F, Tower B, The HQ  
No. 100 Zunyi Road  
Shanghai 200051  
P. R. China  
T +86 21 22262500  
F +86 21 22262512  
**saurer.com**